

## Technical Specifications:

### Parameters

WBC, Lymph#, Mid#, Gran#, Lymph%, Mid%, Gran%, RBC, HGB, HCT, MCV, MCH, MCHC, RDW-CV, RDW-SD, PLT, MPV, PDW, PCT and Histograms for WBC, RBC, PLT

### Principles

Electrical impedance method for cell counting and cyanide free method for hemoglobin

### Performance

Parameter	Linearity	Precision(CV%)
WBC(10 <sup>9</sup> /L)	0.0~100.0	3.0 (7.0~15.0)
RBC(10 <sup>12</sup> /L)	0.00~9.99	3.0 (3.00~6.50)
HGB(g/L)	0~300	2.0 (100~180)
MCV(fL)		1.0 (70.0~110.0)
PLT(10 <sup>9</sup> /L)	0~1000	5.0 (200~500)

### Sample Volume

Prediluted	20 µL
Whole blood	20 µL

### Aperture Diameter

WBC/RBC	80 µm
---------	-------

### Throughput

30 samples per hour

### Display

Color LCD display  
Resolution: 800 x 600

### Menu

Count, Review, Quality Control, Setup, Service, Calibration, Shutdown

### Carryover

WBC < 1.5%; RBC, HGB < 1.0%; PLT < 2.0%

### Input/Output

RS 232 x 2, 1parallel printer (optional), 1 keyboard interface

### Printout

Thermal recorder, printer 50 mm wide paper, multiple printout formats, external printer (optional)

### Operating Environment

Temperature	15°C~30°C
Humidity	30%~85%

### Power Requirement

AC 100-240V, 50/60Hz

### Dimensions

324 mm (W) x 437 mm (H) x 395 mm (D)

### Weight

Less than 23 Kg

## BC-2300

Hematology Analyzer

# BC-2300

## Hematology Analyzer

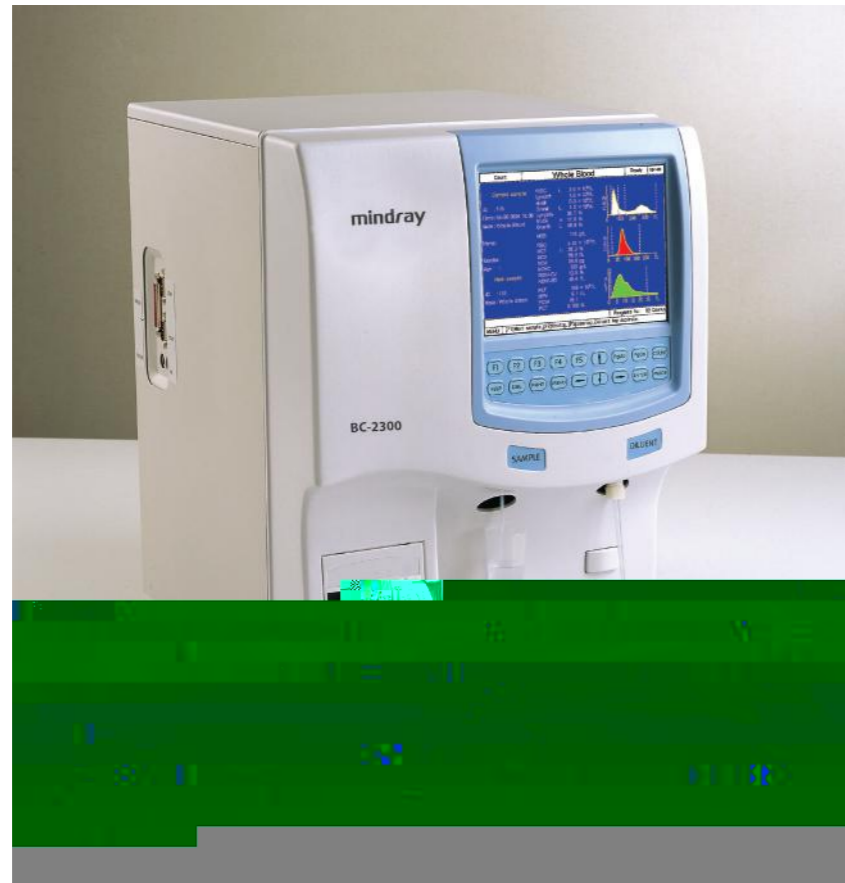

- Compact sized and cost effective
- 3-part differentiation of WBC, 19 parameters + 3 histograms
- 2 counting modes: Whole blood and prediluted
- Throughput: 30 samples per hour
- Automatic clog removal and recount function
- Up to 20,000 patient results (including histograms) can be stored
- Built in diluter and thermal recorder
- Color LCD display

One step manual, a big cost can be saved.



BC-2300 Easy operation procedure

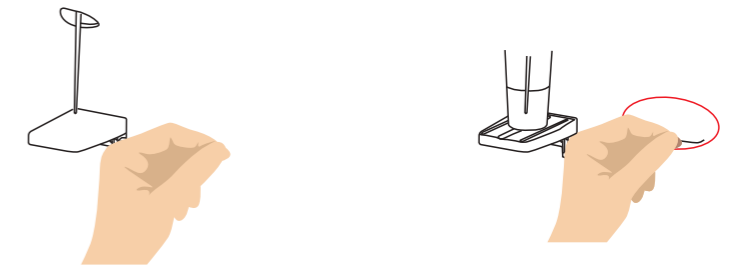

Count	Whole Blood	Ready	18:48
Current sample	WBC 4.28 x 10 <sup>9</sup> /L		
	Lympho 2.8 x 10 <sup>9</sup> /L		
	Mono 0.2 x 10 <sup>9</sup> /L		
	Neutro 1.28 x 10 <sup>9</sup> /L		
RD - 118	RDW-CV 11.5 %		
Time 24:36 2014 10:00	Leuko 26.7 %		
Prep Whole Blood	MCH 31.3 pg		
	MCV 83.8 fL		
Name	HGB 140 g/L		
	HPC 4.01 x 10 <sup>12</sup> /L		
	HCT 30.0 %		
Gender	MPO 88.3 %		
Age	MCHC 36.9 pg		
	MCHC 32.2 g/L		
Neut outside	RBC-UV 22.3 %		
	RBC-SD 44.4 fL		
RD - 118	PLT 160 x 10 <sup>9</sup> /L		
	MPV 2.1 fL		
Prep Whole Blood	PCV 45.1 %		
	PLT 1103 %		
	Reagents for: 18 Counts		
	MENU   [F1]Next sample [F2]Unflag [F3]Starup [F4]Quit Key Asst:Rate		

**Semi-automated**

Manual pre-dilution, saved a big cost

**Cost effective**

Competitive instrument price combined with effective cost per test